



RACE
TO PUSH
THE LIMIT



Mitchell Oldenburg
MCR Honda

usa.afam.com



Race to push the limit

Especially because your safety but also your comfort is important, AFAM offers high quality chains and sprockets. A combination perfectly suited to your motorcycle guarantees you many kilometers of carefree riding pleasure.

The perfect fit since 1978

Applying its experience since 1978, AFAM recommends chain kits with the correct chain required for the performance and use of your motorcycle. Do not take risks, trust AFAM.



Original Equipment Manufacturer (OEM)

Norton

Carolea



SHERCO



QUALITY

Our experiences have taught us that quality always wins. We commit ourselves to continue to guarantee this quality. We constantly develop new products adapted to the high demands of today's motorcycles.

Process

The process starts with the referencing, we then work out the drawing with our quality standards according to the applications and conditions of use.

AFAM products are made from high grade alloys in our various factories around the world. We carry out quality control at all stages of the manufacturing process and at the end just before packaging. The parts are then sent to our facility in Nazareth (Belgium) where a final sample check is carried out before the products are registered in our stock. At AFAM, it is quality above all.

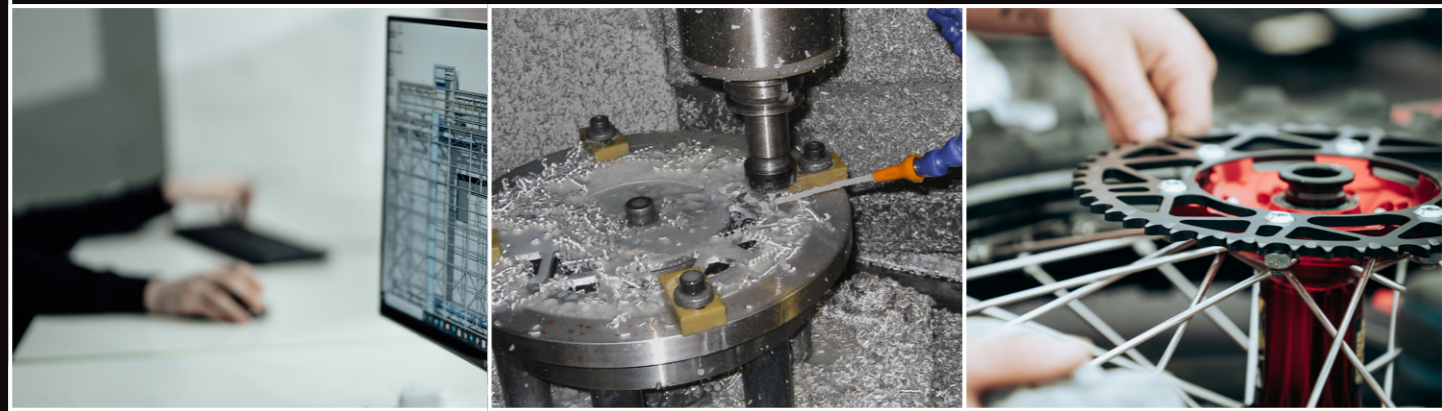

SPROCKETS

FRONT	PAGE 8
REAR STEEL + ALU	PAGE 9



CHAINS

CHAIN TYPES	PAGE 14
FIND YOUR APPLICATION	PAGE 14
CONNECTING LINKS + TOOLS	PAGE 16



SPROCKETS

FRONT

AFAM Front sprockets are manufactured to the highest quality standards with the best steel alloy material. We constantly develop new sprockets adapted to the high demands of today's motorcycles.

ROAD & STANDARD MX Sprocket

AFAM Standard front sprockets are exact replicas of the original front sprockets used on most motorcycles.



MX Sprocket

AFAM Self-cleaning front sprockets are available for MX and Off-Road use. They have holes in order to optimize the weight and have on the tooth bottom, a groove which evacuates sand and mud from the sprocket, this way dirt does not accumulate between sprocket and chain.



REAR

STEEL

AFAM Steel Rear sprockets are the most durable on the market. All CNC machined and produced in C45 normalized steel with induction hardened teeth, which reduces wear on sprocket and chain drastically and ensures a longer life span. The normalized steel prevents the sprocket from micro cracks in the material. Executed in silver (zinc plated) or black (electrophoresis) for a long-lasting protection against corrosion. This assures the quality of the product to offer you a safe ride.

SLK Sprocket

Maximum weight saving (SL Super Light) thanks to its fourth generation T4 design in black color by Black electrophoresis (K Black) and equipped with mud grooves make this sprocket ideal for MX and sand races.



ALU

Aluminum AFAM sprockets are CNC machined in aluminum 7075 T6 and also have the unique AFAM tooth profile.

MX Sprocket

AFAM Motorcross Aluminum Self-cleaning sprockets are color anodized. A mud groove at the bottom of the teeth evacuates sand and mud quickly to avoid over tensioning of the chain.





RACE
TO PUSH
THE LIMIT

Cole Seeley
MCR Honda

CHAINS

AFAM has the correct chain for each motorcycle. Depending on the performance and the use of your motorcycle, you should install an appropriate chain.

A heavy touring motorcycle with passenger and packed with luggage is not the same as a sports motorcycle. A race on a track is not the same as a race on the Isle of Man. The torque of one engine is not the same as on another engine with the same displacement.



High Grade Steel alloys with the correct heat treatment, advanced precision manufacturing methods and tolerances, customized X-Rings when it's needed and high grade grease make up the quality chain of AFAM.



MOTOCROSS

AFAM Motocross chains withstand extreme use because the components are specially treated to wear as little as possible. Sand and mud are indeed not ideal conditions for a chain, and yet you want to win Off-Road races. For these extreme conditions, AFAM has developed specially treated Motocross chains.

AFAM 520MX-GG & -K

Is a Gold superior Motocross chain for professional use. This chain uses advanced techniques derived from MXGP racing. The quality of the components and the precision is truly top so wear is limited, and you obtain a maximum lifespan.

This chain is also available in a Black finishing.

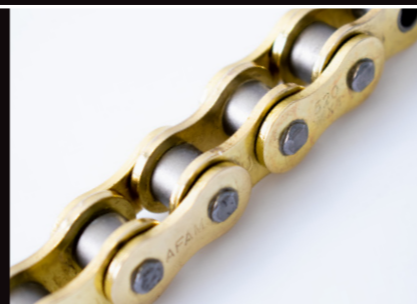

ROAD OFFROAD

Less friction, better transmission, longer lifespan. All these chains are equipped with the AFAM Xs-Ring. It's shape reduces friction and keeps the grease inside the chain long time which guarantees a longer lubrication and increases its longevity. The shape of the Xs-Rings increases the flexibility of the chain, reduces friction and therefore improves your transmission.

AFAM 520XRR-G & -K

Is a reinforced Gold color chain with Xs-Rings for Off-Road use. These Xs-Rings are specially designed to resist wear through sand and mud in order to maintain the flexibility of the chain. The roller diameter has been adapted for Off-Road use to cope better with sand and mud without tensioning the chain.

Also available in a Black finishing.



Xs-Ring

It's the standard today, the Xs-Ring keeps the grease between the pin and the bushing and reduces friction to increase the durability of your chain.

A chain with an Xs-Ring has over 50% more longevity than a chain with an O-Ring.



CHAIN REF	APPLICATION	CONNECTING LINKS				SEAL RING TYPE	CC	PITCH P mm	WIDTH W mm	ROLLER DIAMETER R mm	PIN DIAMETER D mm	PLATE THICK INT/EXT T/t mm	PLATE HEIGHT INT/EXT H/h mm	L1 max mm	L2 max mm	TENSILE STRENGTH daN	WEIGHT / 100 LINKS kg	COLOR	
		STANDARD BOX	AVAILABLE																
			AR	ARS	MR														MRS
520MX6	CROSS	ARS	•	•	•	NONE	250-500	15,88	6,35	10,16	5,24	2,0	15/13	16,8	18,8	3740	1,51	•• GG • K	
520XRR3	OFFROAD/ROAD	ARS	•	•	•	Xs-RING	125-500	15,88	6,35	10,16	5,24	2,0	15/13	19,8	21	3600	1,58	• G • K	

This information is only indicative, always consult our website to find the recommended chain for your bike.

CONNECTING LINK

AR

Standard connecting link with clips. Only for use with mopeds and light motorcycles, loose fit mounting.



ARS

Connecting link with clips, semi press fit mounting. To be mounted with pliers or with the tool EASY RIV5 from AFAM.

MR

Rivet type connecting link with flat pin head. Square riveted, this connecting link has the same shape as the other links in the chain.

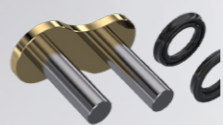

MRS

Rivet type connecting link with hollow pin head. Standard with all Xs-Ring chains and allows you to easily rivet your chain with the AFAM EASY RIV5 tool.

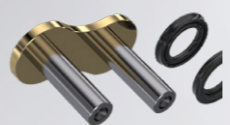

TOOLS

RIVETING TOOL - HOLLOW PIN		PROFESSIONAL CUT AND RIVETING TOOL - HOLLOW PIN	
CHAINS 520 525 530	EASY RIV 5	CHAINS 428 525 520 530	DRCP3



Derek Kelley
AEO KTM



U.S. AIR FORCE
SPECIAL
WARFARE

CHAIN KITS

Since 1978, AFAM recommends you in its chain kits the correct chain and sprockets for many kilometers of carefree riding pleasure. Do not take risks, your safety is the most important. Trust AFAM.

A dominant chain kit technology

Our sprockets are machined according to the real pitch of the chain and not the theoretical pitch. The standard chain in the kits is equivalent to the original chain.

The chain is adapted to the performance of the motorcycle. Different gearings are possible as well as chain upgrades.



> 41K MOTOS

> 10K KITS

> 250K COMBINATIONS





THE PERFECT
FIT SINCE 1978



AFAM USA

afamusa@afam.com

usa.afam.com

[f @ /afam.group](https://www.facebook.com/afam.group)

